

August 22, 2013

**NOTICE OF PREPARATION AND NOTICE OF PUBLIC SCOPING
MEETING FOR AN ENVIRONMENTAL IMPACT REPORT**

PROJECT NAME: Los Angeles International Airport (LAX) Runway 6L-24R Safety Area and Associated Improvements

PROJECT LOCATION/ADDRESS: On the North Airfield of the LAX property in the City of Los Angeles, County of Los Angeles (see Figure 1).

COMMUNITY PLANNING AREA: LAX Plan

COUNCIL DISTRICT: 11- Bonin

DUE DATE FOR PUBLIC COMMENTS: Monday, September 23, 2013 by 5:00 p.m.

Los Angeles World Airports (LAWA), a proprietary department of the City of Los Angeles, will be the lead agency and will prepare an Environmental Impact Report (EIR) for the project identified below (proposed Project). LAWA requests your comments as to the scope and content of the EIR. The purpose of the scoping meeting is to receive input from the public as to what areas the EIR should study. No decisions about the proposed Project are made at the scoping meeting.

The Project description, requested permits and approvals, and the potentially significant environmental effects of the proposed Project are set forth below. Also included below are the date, time, and location of the scoping meeting that will be held in order to solicit input regarding the content of the Draft EIR. The scoping meeting will be in an open house format. A copy of the Initial Study prepared for the proposed Project is available for review at the LAX website at: <http://www.ourlax.org> and at the locations listed below:

Westchester-Loyola
Village Branch Public Library
7114 West Manchester Avenue
Los Angeles, CA 90045

El Segundo Library
111 W. Mariposa Avenue
El Segundo, CA 90245

PROJECT DESCRIPTION:

The intent of the proposed Project is to comply with the “Transportation, Treasury, Housing and Urban Development, the Judiciary, District of Columbia, and Independent Agencies Appropriations Act, 2006” (Public Law [P.L.] 109-115), November 30, 2005. P.L. 109-115 requires completion of Runway Safety Area (RSA) improvements by airport sponsors that hold a certificate under Title 14, Code of Federal Regulations (CFR), Part 139, Certification and Operations: Land Airports Serving Certain Air Carriers, such as LAX, to meet Federal Aviation Administration (FAA) airport design standards by December 31, 2015. LAWA prepared an RSA Practicability Study and concluded that the existing RSA for Runway 6L-24R does not meet current airport design standards and improvements to the RSA were needed. Additionally, Runway 6L-24R, as the primary arrivals runway on the north airfield, handles a large amount of traffic. Due to heavy usage over the years, sections of the pavement have deteriorated and need reconstruction.

As depicted on Figure 2, the proposed Project would include (1) implementing declared distances by reducing the Runway 6L accelerate-stop distance available (ASDA) and landing distance available (LDA) by 359 feet; (2) realigning portions of two service roads; (3) covering a portion of the Argo Ditch; (4) rehabilitating portions of the Runway 6L-24R pavement; (5) relocating or removing security gates and an Air Operations Area (AOA) fence; and (6) parking area closures. The proposed Project would not result in increased or decreased aviation activity at LAX compared to existing conditions.

REQUESTED PERMITS/APPROVALS: The City of Los Angeles has principal responsibility for approving and carrying out the proposed Project. Approvals required for implementation of the proposed Project may include, but are not limited to, the following: U.S. Department of Transportation Federal Aviation Administration (FAA) approval of an FAA Notice of Construction or Alteration; FAA approval of NEPA documentation assessing the proposed Project; South Coast Air Quality Management District (SCAQMD) review; Permits or approvals from the State Water Resources Control Board (SWRCB) and/or Regional Water Quality Control Board (RWQCB) which may include (1) General Construction Storm Water Permit; (2) Standard Urban Stormwater Mitigation Plan; and (3) submittal of a Recycled Water Report to the RWQCB for the use of recycled water as a dust control measure for construction; Certification of the Final EIR and associated Mitigation Monitoring and Reporting Program; LAX Plan Compliance Review; Los Angeles Bureau of Sanitation, Watershed Protection Division approval of a Project-Specific Storm Water Management Plan or Standard Urban Storm Water Mitigation Plan; Los Angeles Fire Department approval; Los Angeles Department of Building and Safety grading and building permits; Los Angeles Department of Public Works permits for infrastructure improvements; and other Federal, State, or local approvals, permits, or actions that may be deemed necessary for the proposed Project.

ENVIRONMENTAL FACTORS POTENTIALLY AFFECTED: Air Quality, Biological Resources, Greenhouse Gas Emissions, Hazards and Hazardous Materials, Hydrology and Water Quality, Noise, Transportation/Traffic, and Mandatory Findings of Significance have been found to have potentially significant impacts and will be analyzed in an Environmental Impact Report (EIR) prepared for this proposed project. Impacts to Aesthetics, Agricultural and Forestry Resources, Cultural Resources, Geology and Soils, Land Use and Planning, Mineral Resources, Population and Housing, Public Services, Recreation, and Utilities and Service Systems have been found to be less than significant through the analysis in the Initial Study and are not proposed for further analysis in the EIR.

PUBLIC SCOPING MEETING DATE AND LOCATION: A public scoping meeting in an open house format will be held to receive public comment regarding the scope and content of the environmental information to be included in the EIR. LAWA encourages all interested individuals and organizations to attend the meeting. The location (see Figure 3), date, and time of the scoping meeting for this proposed Project is as follows:

Dates and Times: **September 5, 2013, 6:00 p.m. to 8:00 p.m.**
Arrive any time to speak one-on-one with LAWA staff and Project consultants.

Location: **Fire Station 5, Los Angeles Fire Department**
8900 South Emerson Avenue
Los Angeles, California

LAWA welcomes all comments regarding the content and scope of environmental issues to be addressed in the EIR. **All comments will be considered in the preparation of the EIR. Written comments must be submitted to this office by 5:00 p.m. on September 23, 2013.** Written comments will also be accepted at the scoping meeting described above.

Please direct your comments to:

Evelyn Quintanilla, City Planner
Capital Programming and Planning Group
1 World Way, Room 218
Los Angeles, CA 90045
Phone: (800) 919-3766

Comments can also be submitted on the LAX website at <http://www.ourlax.org>.



EVELYN QUINTANILLA
Capital Programming and Planning Group

Enclosures:

- Figure 1: General Location and Vicinity Map
- Figure 2: Runway 6L-24R Proposed Project
- Figure 3: Scoping Meeting Location

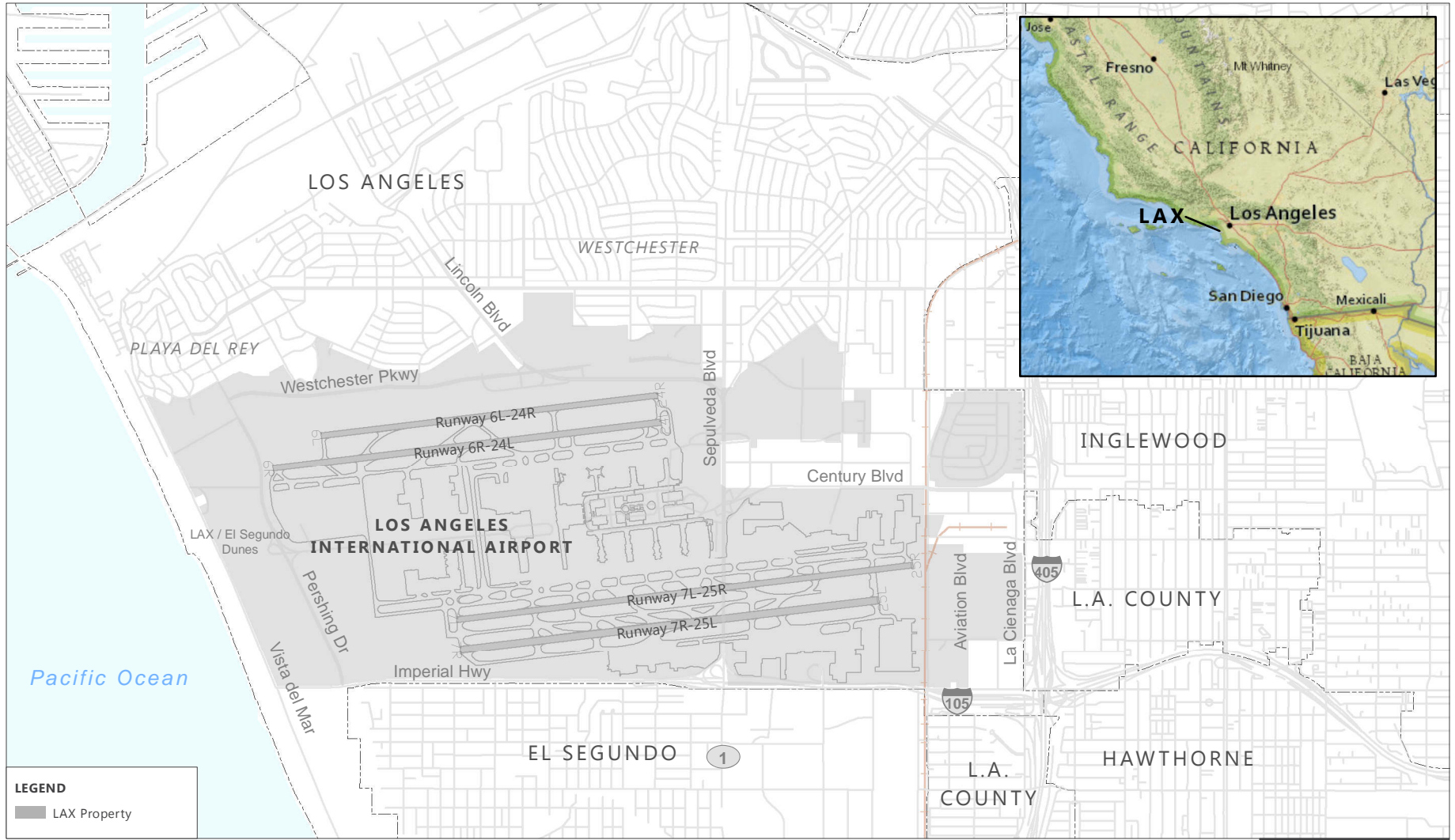
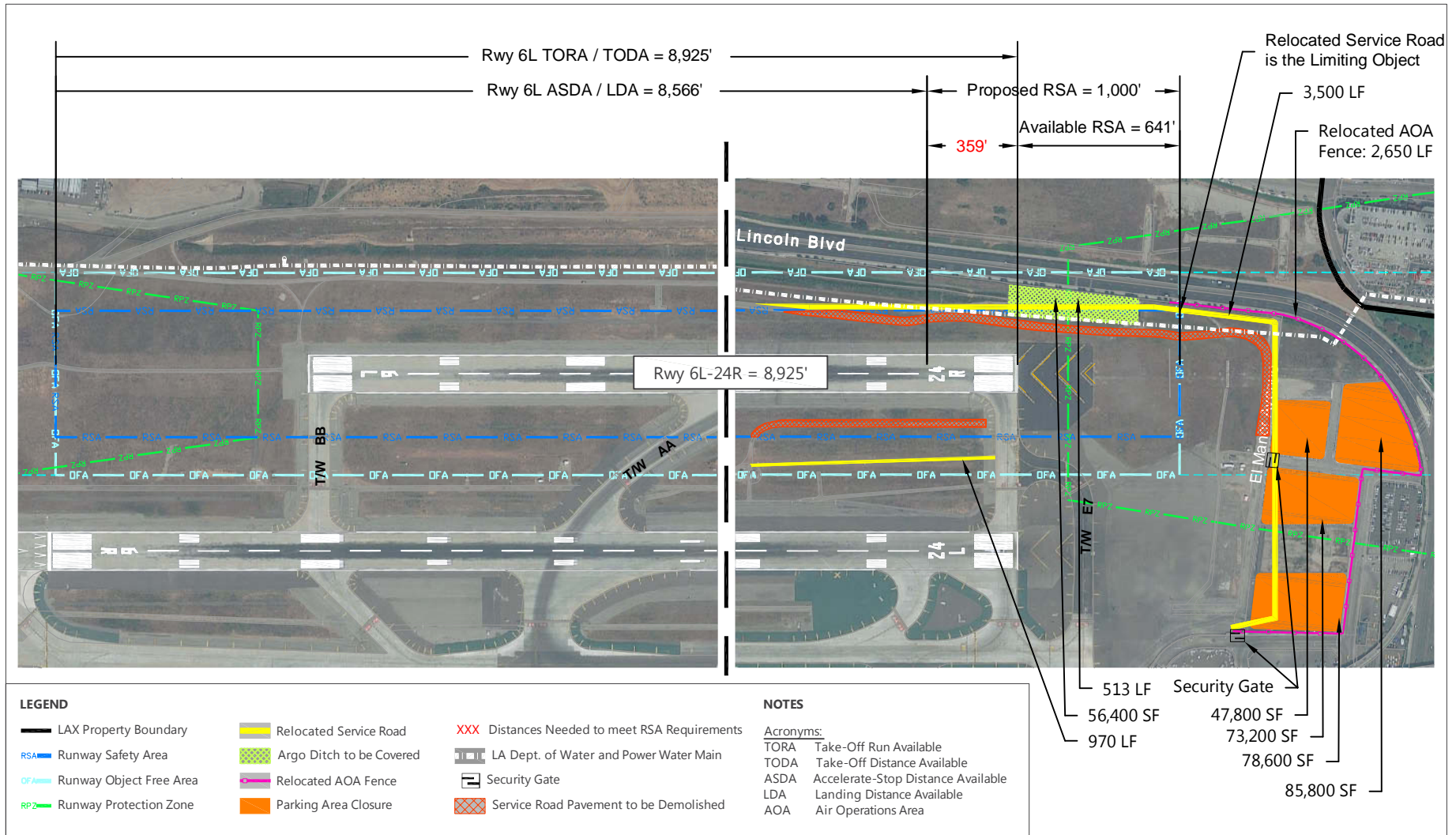

FIGURE 1



General Location and Vicinity Map



SOURCE: Federal Aviation Administration, *Advisory Circular 150/5300-13A, Airport Design*, September 28, 2012; Landrum & Brown, *Los Angeles International Airport, Airport Layout Plan*, 2005; Los Angeles World Airports, April 2013 (aerial photography); Ricondo & Associates, Inc., August 2013.
 PREPARED BY: Ricondo & Associates, Inc., August 2013.

FIGURE 2

**Runway 6L-24R
Proposed Project**



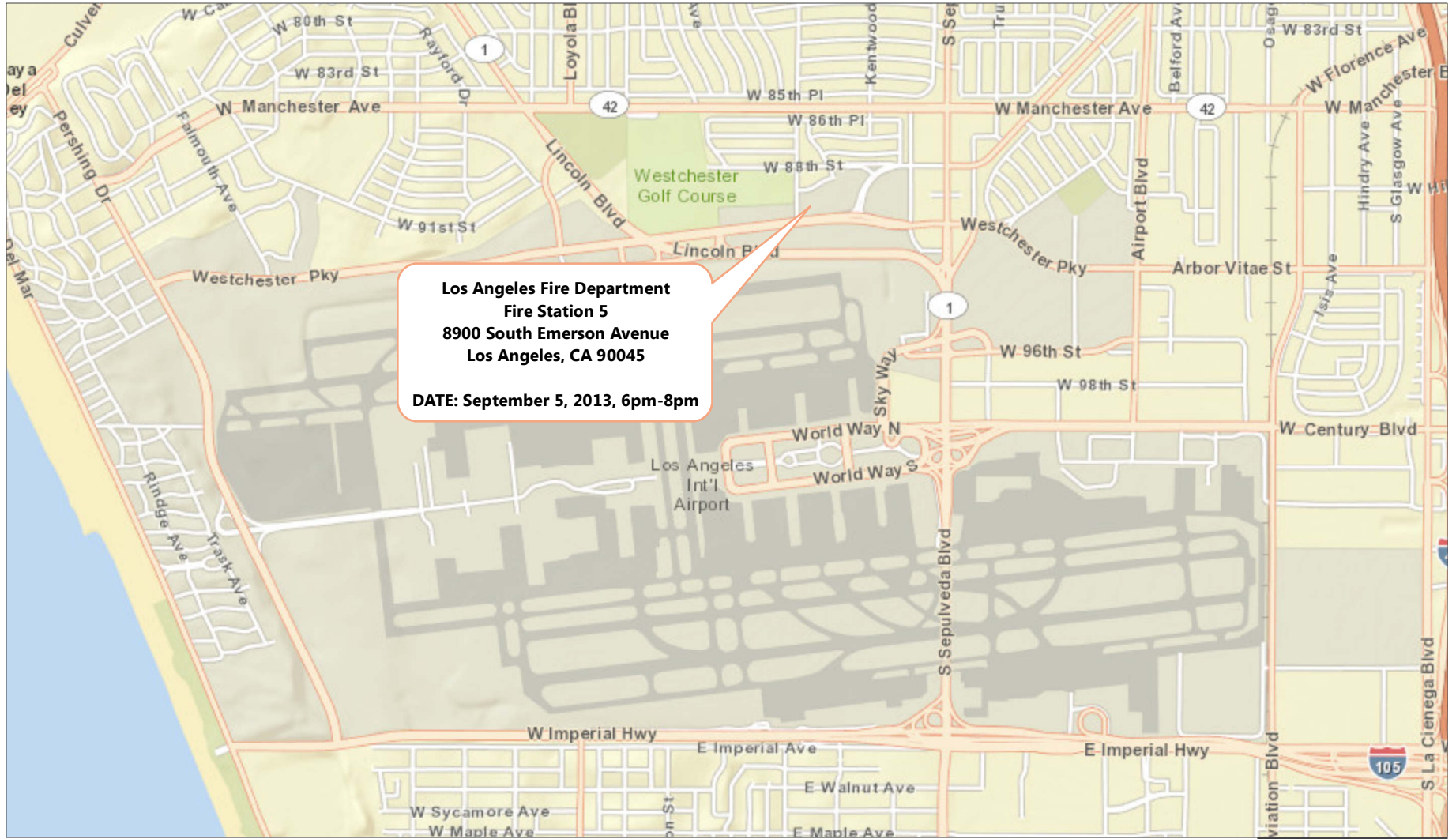

SOURCE: Environmental Systems Research Institute, 2009 (street map).
 PREPARED BY: Ricondo & Associates, Inc., August 2013.

FIGURE 3



G:\Projects\LosAngeles\North RSA EALAX_meeting_loc_0080113.mxd

Scoping Meeting Location
 Los Angeles Fire Department, Fire Station 5